

WiGauge™ Multichannel

Following from the successful single channel Wigauge™, Solartron can now offer a Wigauge™ with up to 8 transducers, This enables the user to construct a wide range of wireless measuring heads for applications like crank gauges and multiple bore gauges



**Multi sensor Bore
Gauge using DUSM
and Mini Probes**



**Multi sensor outer
diameter gauge with
taper check**

Available with Inductive Battery Charging

 **wigauge**[™]

WiGauge™ Multichannel Unit

Description

The freedom to roam with Solartron's WiGauge™ brings increased efficiency to gauging stations and work practices. The ability to work without cables means that the gauging process is not restricted by cable length and routing, or the risk of cable damage.

The reading is logged into a system that can be up to 15 metres away. The rugged construction and class 1 Bluetooth® communication ensure that it is able to work reliably in the often hostile environment of an engineering machine shop

Post process gauging stations become more flexible and with the ability to connect multiple WiGauge™ to a single receiver, cable tangles are eliminated in multi-point gauging applications.

Features

- ▶ Can be integrated with up to 8 Solartron transducers to form multifunctional wireless hand gauges, such as snap gauges or multi-sensor bore gauges
- ▶ < 0.1 µm resolution
- ▶ Up to 15 metre data transmission, via class 1 Bluetooth®
- ▶ Multiple WiGauge™ connected to a single system
- ▶ 5 hours battery life (based on continuous data transmission) off charger.
- ▶ Inductive battery charging system
- ▶ IP65 protection (Handle)
- ▶ Audio indication of data transmission





Technical Specification

Product	Multichannel Wireless Hand Tool
	WHTM/n
	n= number of connected sensors
Measurement Performance	
Measurement Range (mm)	depends on selected sensor
Accuracy (% of Reading) (Note 1)	depends on head construction
Repeatability (µm) (Note 1)	depends on head construction
Resolution (µm)	0.1
Environmental	
Sealing	IP65 (handle)
Storage Temperature (°C)	+5 to +60
Operating Temperature (°C)	+5 to +50
EMC Emissions	EN61000-6-3
EMC Immunity	EN61000-6-2
EMC Immunity	EN 61326-1:2013
EMC Standard for Radio Equipment	EN 301 489-1
EMC for Wideband transmission systems	EN 300 328
Shock	Do not subject to excessive shocks or loads
Life	Greater than 10 million cycles depending on application
Material	
Handle and Internals	ABS, Nylon, Stainless Steel
Interface	
Bluetooth	Class 1 Range 15m Class 2 and 3 selectable
Reading Rate	Up to 100 readings/second
Power	Rechargeable battery pack
Display	Colour LCD with acrylic sealed cover
Front LED Indication	Blue LED - Steady Bluetooth available, Flashing Bluetooth Connected
Front LED Indication	Red - Led Continual - low battery warning
Front Control Button and Rear Control Button	User Configurable
Other	Selectable power down options Tagged readings on button press Continual Streaming

Note 1: Accuracy and repeatability depends on construction of head

The Bluetooth® word mark and logos are registered trademarks owned by Bluetooth SIG, Inc and any use of such marks by Solartron Metrology is under license. Other trademarks and trade names are those of their respective owners.

Display Configuration

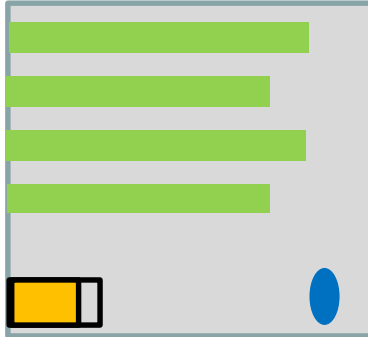

Bars to indicate position

Battery Level

Bluetooth Indication

Dimensions (mm)

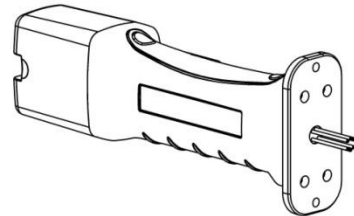
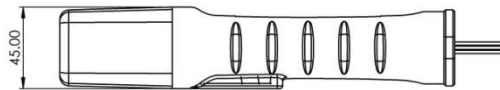
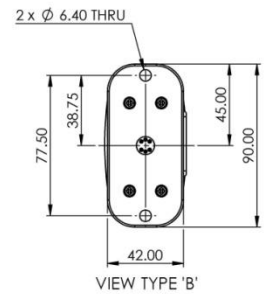
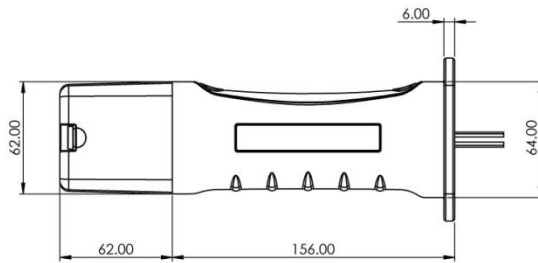

Inductive Battery and Charging

The WiGauge™ is supplied with an inductive battery and charger.

Inductive Charged Battery Pack

This pack is charged whenever the tool is placed in the inductive charger cradle. Charge time from fully discharged is in the region of 14 hours, however as the tool will normally be left in the charger between operations, the pack will remain charged. The cradle must be connected to the charger PSU module to operate correctly, one PSU module can power up to 4 inductive cradles.

Solartron offer two cradle types for different installations, either measuring head pointing up or pointing down

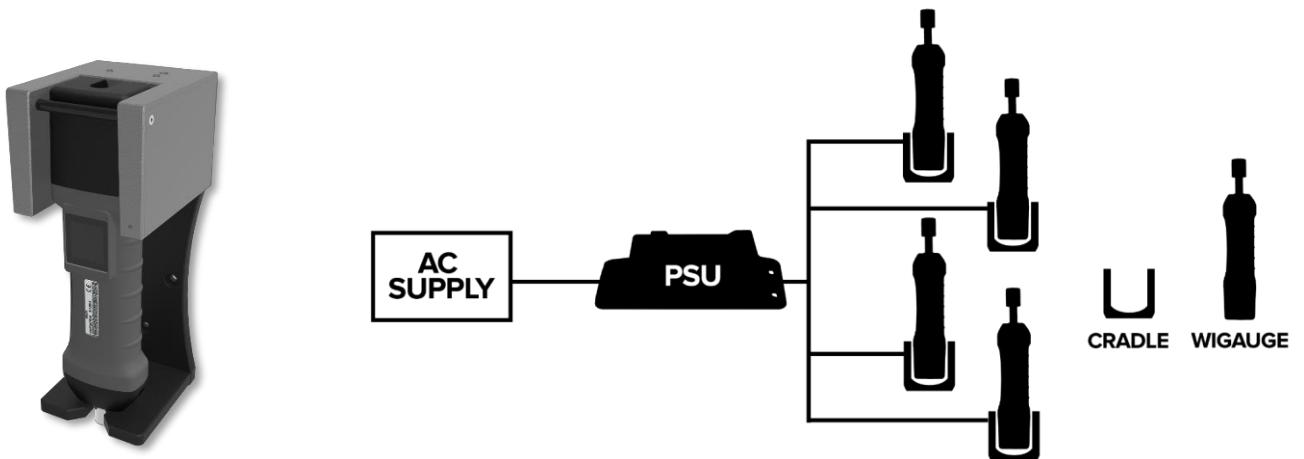

 **Bluetooth**[®]



Setting up the WiGauge™ to communicate with a Bluetooth® enabled Windows® based PC is quick and easy.

Solartron Metrology recommends using the Bluetooth® USB adapter supplied with the WiGauge™ pack to obtain the most reliable data communication to the PC.

Inductive Cradle Dimensions (mm)

Type A

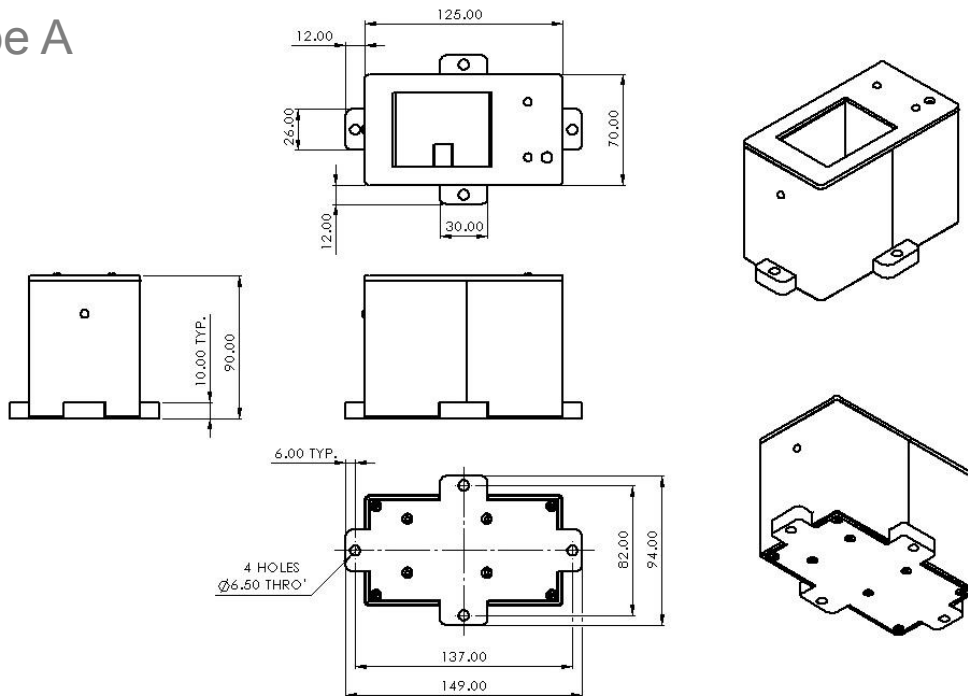

Type B

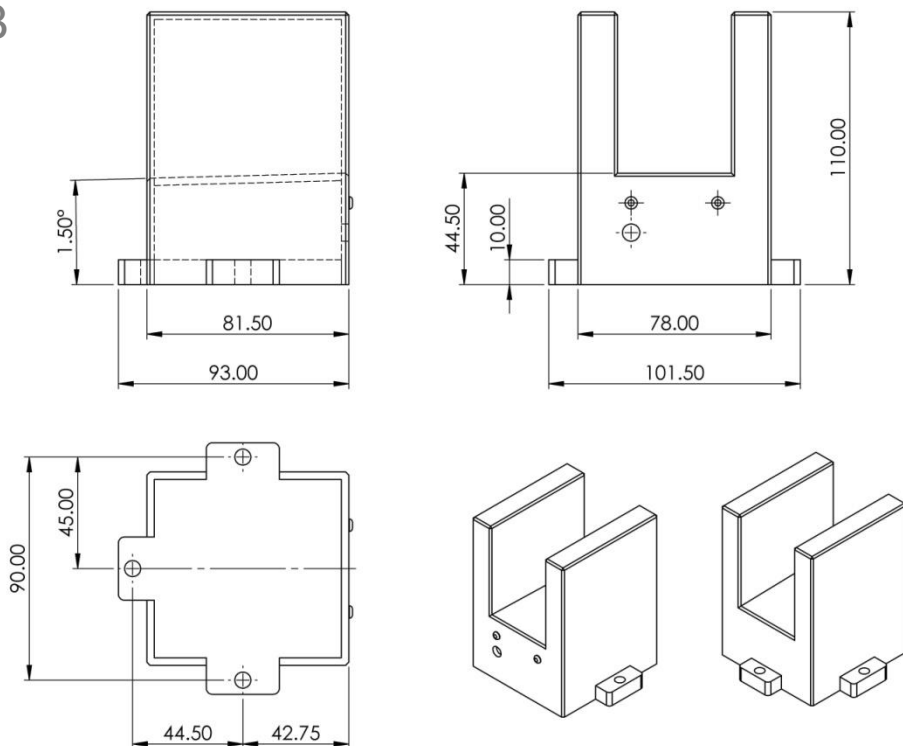

Precision through Innovation

@IMTmetrology

INNOVATIVE
MEASUREMENT
TECHNOLOGY LTD.



Innovative Measurement Technology Ltd

Unit 3E Vinnetrow Business Park
Vinnetrow Road, Chichester
West Sussex PO20 1QH
United Kingdom

E-mail: sales@imeasure.co.uk
E-mail: support@imeasure.co.uk
Tel: +44 (0) 1243 942010

www.innovative-measurement-technology.co.uk

The contents of this literature are as of January 2023. Innovative Measurement Technology reserves the right to change product specifications without prior notice.

©2023 Innovative Measurement Technology Ltd

