

- Magnetic principle
- Excellent resistance to workshop conditions (DL310B: IP64). Resistant to dust and vibrations.
- Compact size ideal for designing into machines.
- A/B phase output by open collector
- Measuring range: 10 mm / 0.39" and 30 mm / 1.18"

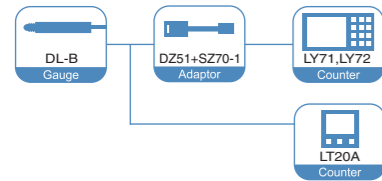

Digital Gauge

Dimensions

DL310B

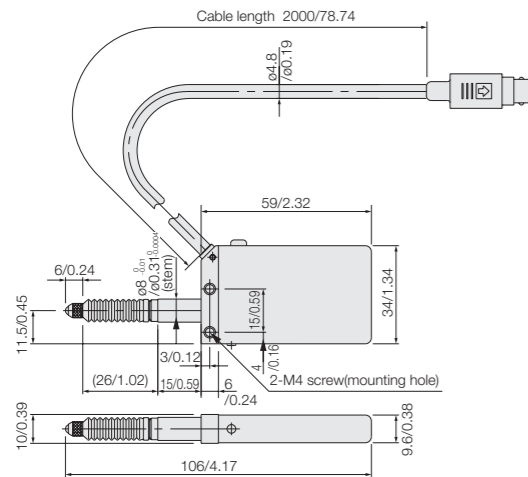

DL330B

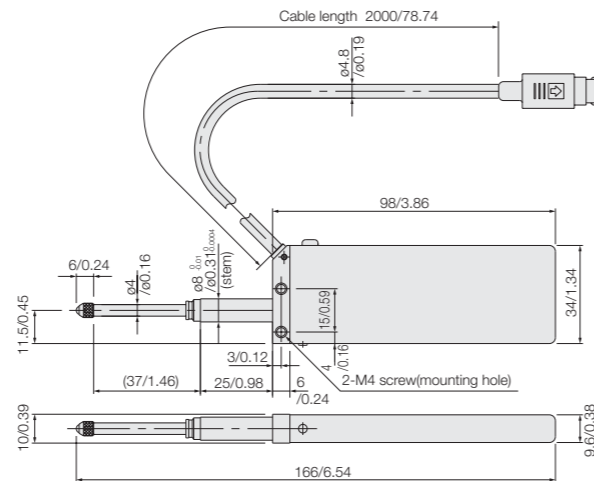

Unit : mm/inch

Specifications

Model	DL310B	DL330B
Measuring range	10 mm/ 0.39"	30 mm/ 1.18"
Resolution	10 μm	10 μm
Accuracy (at 20 °C / 68 °F)	10 μm	10 μm
Measuring force	1.5 N or less	1.5 N or less
Output signal	A/B phase by NPN open collector (12 VDC, 10 mA or less)	
Maximum response speed*1	120 m/ min	
Protective design grade	Equivalent to IP 64	
Mounting stem diameter	ø 8 ^{+0.01} mm / ø 0.31 ^{+0.0004} "	
Operating temperature	0 °C to 50 °C / 32 °F to 122 °F	
Storage temperature	-10 °C to 60 °C / 14 °F to 140 °F	
Power supply	5 VDC ± 5%	
Power consumption	0.2 W	
Cable length	2 m / 6.56 ⁺²	
Feeler	Feeler tipped with 3 mm dia. carbide ball with M2.5 x 0.45 screw on fitting end (DZ123)	
Mass (excl. cable unit)	60 g / 2.12 oz	90 g / 3.17 oz
Vacuum pressure for Air lifter	6.0 x 10 ⁴ to 7.5 x 10 ⁴ Pa	—

*1: Max. response speed of the electrical circuit.

*2: Please consult our sales for more than 2m.

*Consult us when using DL310B/ 330B with the probe facing upward.

Accessories

DZ51 (Relay adapter) For connections of DG-B, DL-BR, DL-B and DT12/32N/P* to LG, LH and LY displays



*To connect the DT12/32N/P, use the DZ51 in combination with the MT10 detector.

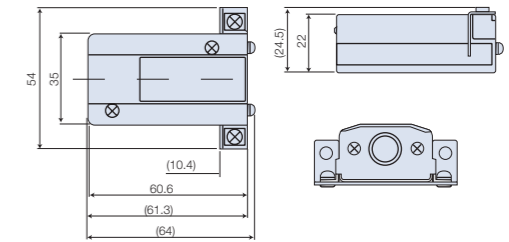

Unit : mm

DZ-811 Bushing (for mounting a U60A or a DE30BR to a DZ-501 stand)

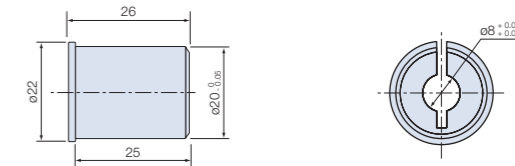

Unit : mm

DZ173 Air release (for DE12BR/30BR, U Series)

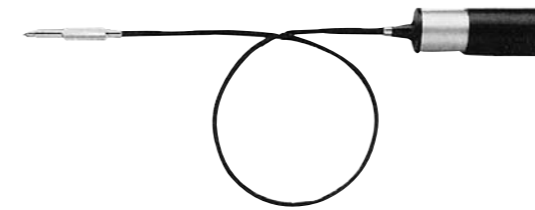

DZ175-010 Air Lifter (for DL10BR) -030 (for DL30BR) -060 (for DL60BR)

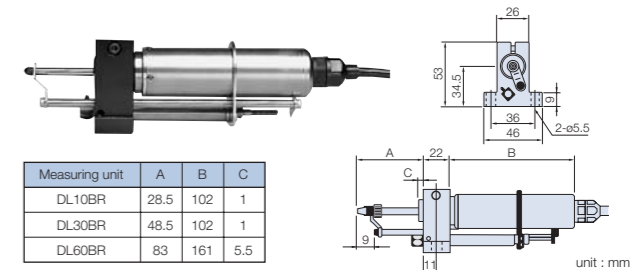

Unit : mm

DZ301 Bellows set (for DL330B, DE30BR)

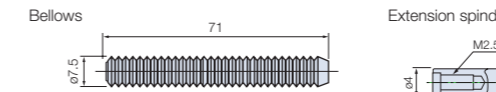

Extension spindle

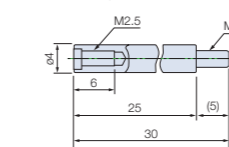

•With the extension spindle attached, the spindle is extended by 25 mm and the measuring force increases by about 0.3 N.

Unit : mm

DZ-191 Coupling

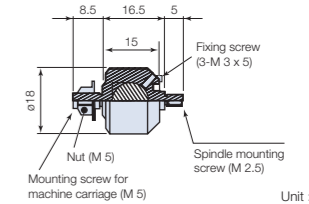

Unit : mm

SZ70-1 Adapter

SZ70-1 is required for connecting the following scale units and counters:

Gauge unit: DE-BR Series, DG-B Series

Counter: LY71 and LY72

* Adapter DZ51 is also required

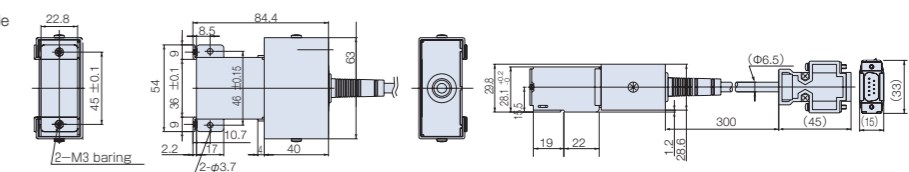

Unit : mm

*Please refer to p54 for the details of the screw.